

MGL-LICHT GmbH
 Steinweg 12-16
 32657 Lemgo
 Germany
 Tel. +49 (0)5261/ 6608818
www.mgl-licht.de <<http://www.mgl-licht.de>>
info@mgl-licht.de <<mailto:info@mgl-licht.de>>

STRAHLER SPOT Z1100+(5024/5025/5026/5027)

Installation to be executed by qualified and educated installers only
 For indoor use only.

The light source contained in this luminaire shall only be replaced by the manufacturer or his service agent or a similar qualified person.

FIG-1

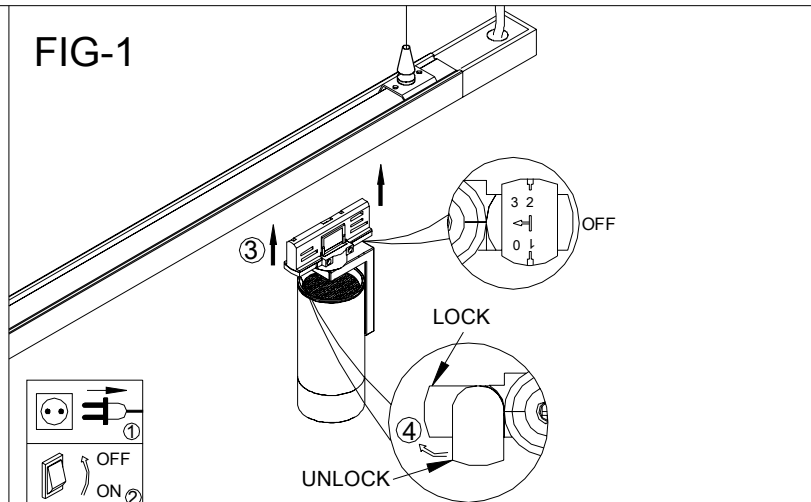

FIG-2

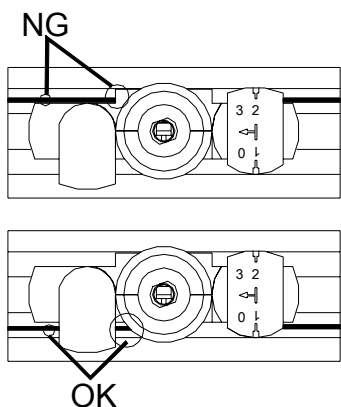

FIG-3

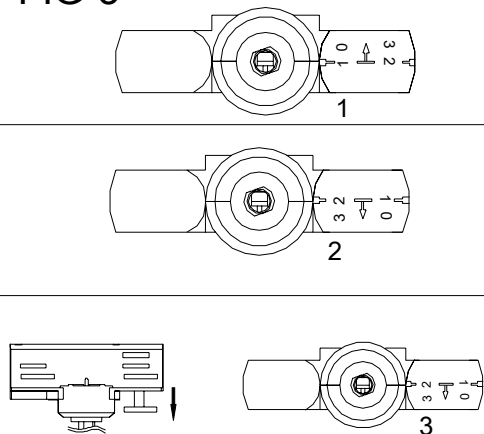
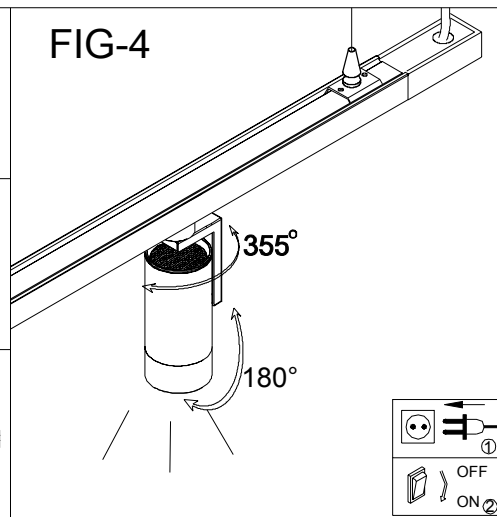

FIG-4



VER:1.1

MGL-LICHT GmbH
 Steinweg 12-16
 32657 Lemgo
 Germany
 Tel. +49 (0)5261/ 6608818
www.mgl-licht.de <<http://www.mgl-licht.de>>
info@mgl-licht.de <<mailto:info@mgl-licht.de>>

STRAHLER SPOT Z1100+(5024/5025/5026/5027)

Installation nur durch qualifizierte Fachkräfte des Elektrohandwerks
 oder entsprechend ausgebildetes Personal

Nur für Anwendungen im Innenbereich.

FIG-1

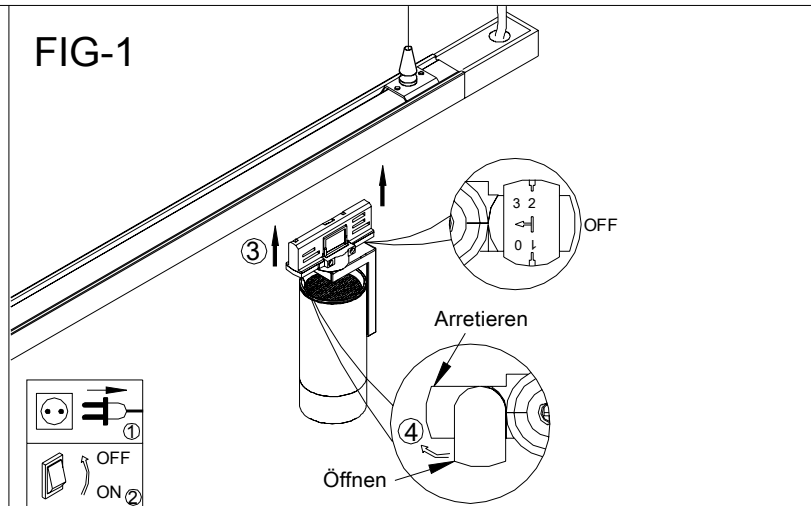

FIG-2

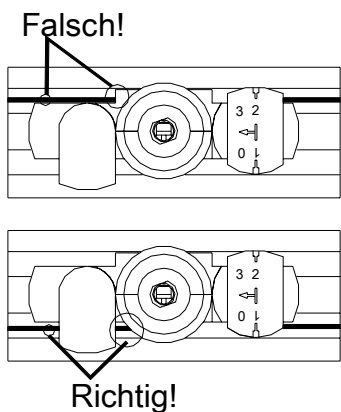

FIG-3

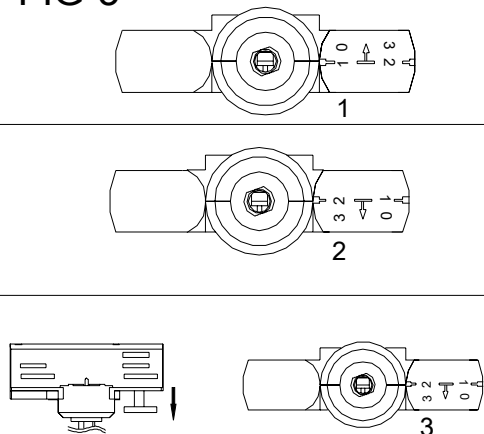
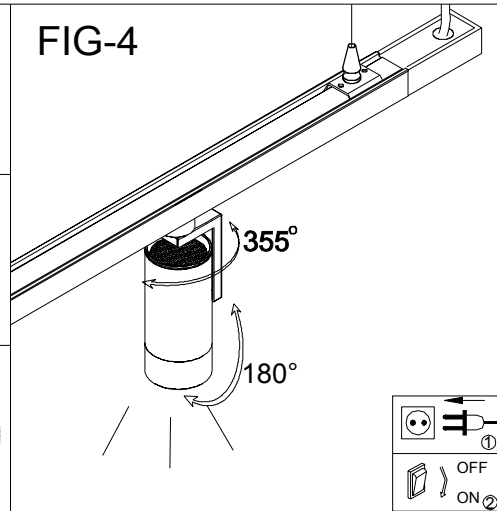

FIG-4



VER:1.1